

PIANO TERRA

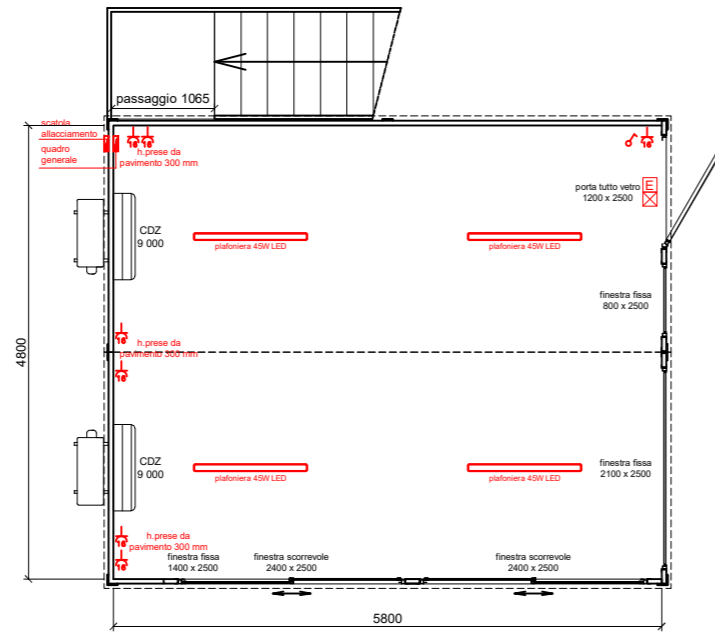

PIANO PRIMO TERRAZZO SOLO BASAMENTO

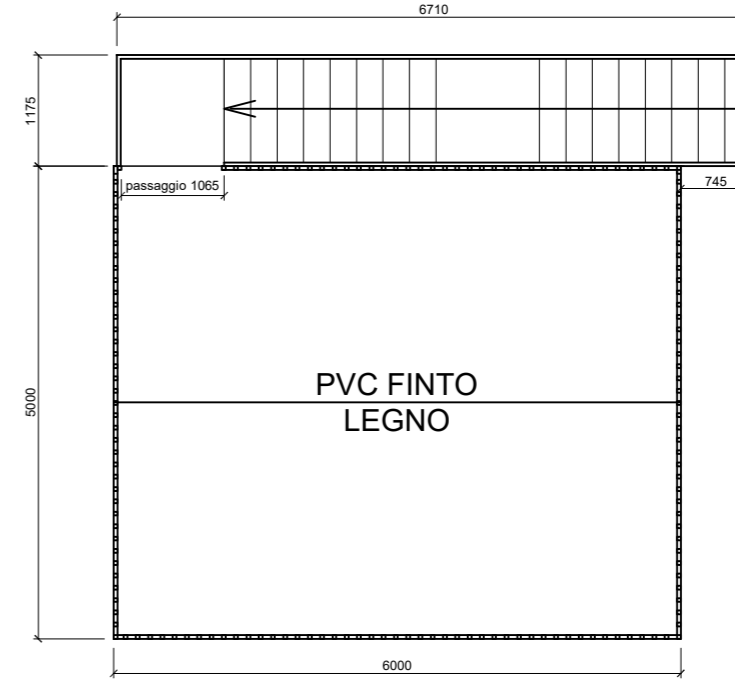

PROSPETTO FRONTALE

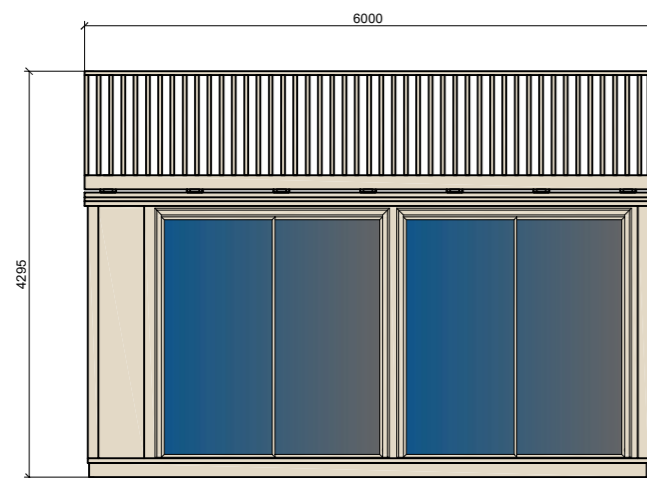

PROSPETTO LATERALE SX

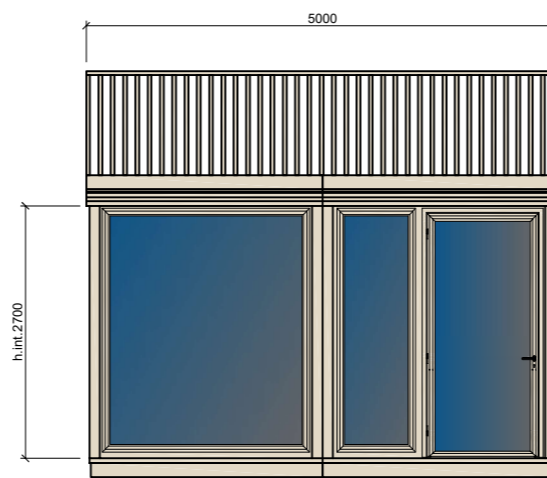

PROSPETTO POSTERIORE RIBALTATO DI 180°

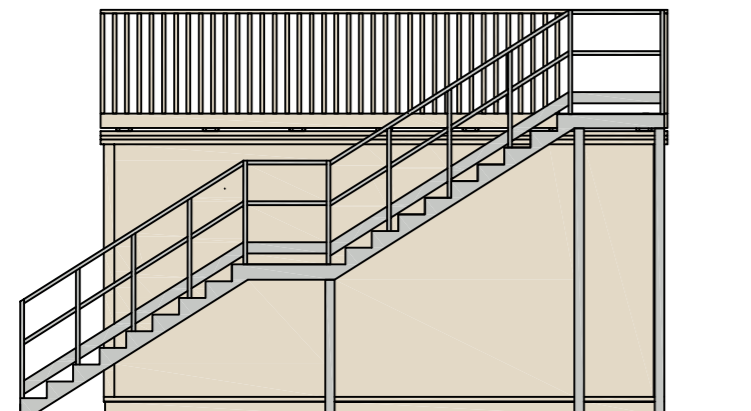

PROSPETTO LATERALE DX

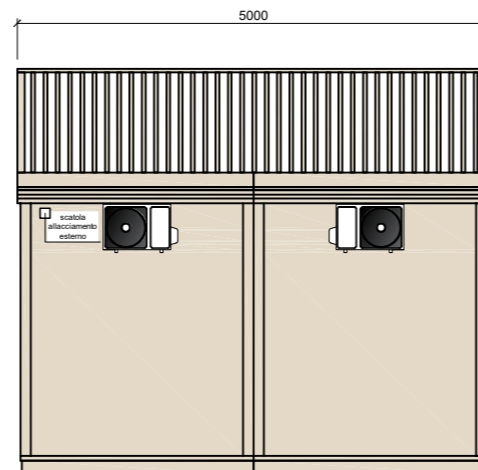

NOTE:

- Pannelli parete lato esterno RAL 1013;
- Telaio serramenti RAL 1013;
- Parapetto primo piano con tubolari 40 x 40 mm;
- Opzione vetro STOPSOL;

PAVIMENTO VINILICO A DOGHE		PANNELLO BASAMENTO	---	---
		PANNELLO PARETE	sp. 50 mm	LISCIO
		PANNELLO TETTO	sp. 50 mm	LISCIO
		LAM. GRECATA	h. 40 mm	
		TIPO DI LEGNO	CEMENTO	
COLORE STRUTTURA		RAL 1013		

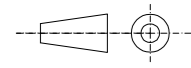
STATO DISEGNO		SCALA	
004		1:80	
003		NUMERO DISEGNO	
002		PG 4431	
001	Revisione	21/05/2024	CLIENTE
000	Emissione	14/05/2024	



PIGRECO GROUP SRL
 Via A. Volta, 02
 24060 TORRE DE ROVERI (BG)
 tel. +39 035 4521281
 www.pigrecomonoblocchi.it